



## Mobile Generator – AG75 Specifications

### ENGINE

- John Deere® PE4045TF285 - turbocharged, diesel engine
  - Prime - 91 hp @ 1800 rpm
  - 4 cylinder
  - 4.5 L displacement
  - Tier III approved
- Steel, single wall fuel tank
  - 147 gal. capacity
  - 24 hr. run time – full load
  - Fuel tank built into skid of generator set
- Fuel consumption at prime:
  - 100% - 5.6 gph (21.2 Lph)
  - 75% - 4.2 gph (15.9 Lph)
  - 50% - 2.8 gph (10.6 Lph)
- Cooling system capable of operating at 120°F ambient
- Low coolant shutdown
- Radiator and oil drains plumbed to exterior
- Rubber vibration dampers isolate engine/generator from frame
- Disposable air filter - paper element
- Air cleaner restriction indicator mounted on control panel
- 60 Hz engine/generator
- Electronic isochronous governing



### GENERATOR

- Marathon Electric®
  - Brushless
  - 4 pole
  - Class H insulation
- Voltage regulation +/- 1% with Marathon SE350 Voltage Regulator

### SYSTEM OUTPUT

- 3 position selector switch
  - Single phase – 120 / 240V Zig Zag
  - Three phase – 120 / 208V Low Wye
  - Three phase – 277 / 480V High Wye
- 56 kW / 56 kVA – standby, single phase
- 52 kW / 52 kVA – prime, single phase
- 63 kW / 79 kVA – standby, three phase
- 58 kW / 72 kVA – prime, three phase

## SYSTEM CONTROLS

- Microprocessor-based controller
  - Backlit, 128x64 pixel resolution display
  - 40°F to 185°F operating temperature range
  - Thermostatically controlled LCD heater
  - Six LED indicators w/ lamp test
    - Alarm / Fault (Red)
    - Ready / Manual (Red)
    - Running (Green)
    - Warning (Yellow)
    - Ready / Auto (Green)
    - Supplying Load (Green)
- Push buttons for easy operation
  - Manual or Auto Start
  - Engine Start or Stop
  - Alarm Cancel & Fault Reset
  - Scrolling Arrows for Diagnostic Information
    - System kW output display
    - Line output & frequency display
    - Engine diagnostic display
      - Oil pressure
      - Engine temperature
      - Fuel level
      - Battery
    - System hours
      - Running hours
      - kW hours
      - Time to service
  - Alarm list – warnings / shutdowns are date & time stamped
    - Fuel level: warning – 15%; shutdown – 5%
    - Overspeed protection: shutdown – 115%
    - Oil pressure: warning – 25 psi; shutdown – 20 psi
    - Coolant temperature: warning – 220°F; shutdown – 230°F
    - Battery voltage: over – 15VDC; under – 11VDC
    - Generator over voltage: warning – 110%; shutdown – 111%
    - Generator under voltage: warning – 87%; shutdown – 86%
    - Generator over frequency: warning – 105%; shutdown – 110%
    - Generator under frequency: warning – 95%; shutdown – 90%
    - Over current shutdown

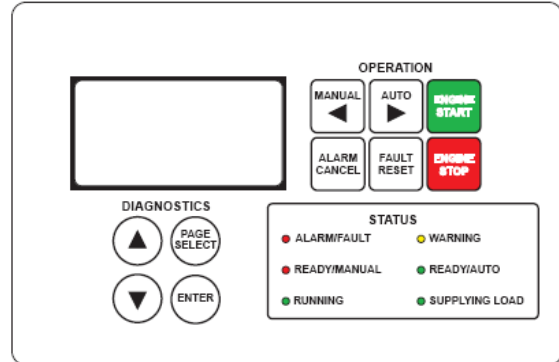

## ELECTRICAL CONTROLS

- Remote start / stop contacts located next to lug box
- Lockable control box door with diagnostics window
- Lockable lug box with safety switch
  - Trips main breaker when door is opened
  - Disables voltage regulator

- Cable entry guides to the lug box
  - Provides separation for cables
  - Restricts access of foreign objects
- Output ground connection lug inside lug box
- 300A main breaker with shunt trip
- Convenience receptacles with individual breakers (restricted use in high wye mode)
  - (2) 120V 20 Amp GFCI duplex outlets – (Nema 5-20R type)
  - (3) 125 / 250V 50 Amp, 3 pole, 4 wire twistlock (Non-Nema 6369)
- Panel mounted rheostat for voltage adjustment - +/- 10%
- 720 CCA wet cell battery

## ENCLOSURE

- Aluminum, sound attenuated enclosure
  - UV & fade resistant, high temperature cured, white polyester powder paint
  - Insulated and baffled
  - 68 dB(A) at 23 feet – prime power
- Fully lockable enclosure including doors and fuel fill
- Stainless steel hinges on doors
- Emergency stop switch located on outside of enclosure
- Central lifting point
- Multi-lingual operating/safety decals
- Document holder with operating/parts manuals including AC/DC wiring diagrams

## TRAILER

- DOT approved tail, side, brake, and directional lights
  - Recessed rear lights
- Transportation tie downs
- Safety chains with spring loaded safety hooks
- 3" lunette ring hitch
- 6000 lb. axle with surge brakes
- 3000 lb. tongue jack with footplate
- ST225/75R15 tubeless tires – 8 ply

## WEIGHTS & DIMENSIONS

### Skid mounted

- Dry weight: 3115 lbs (1413 kg)
- Operating weight: 4074 lbs (1848 kg)
- 96 x 38 x 62 in  
(2.44 x 0.97 x 1.58 m)

### Trailer mounted

- Dry weight: 3850 lbs  
(1746 kg)
- Operating weight: 4809 lbs  
(2181 kg)
- 158 x 60 x 84 in  
(4.01 x 1.52 x 2.13 m)

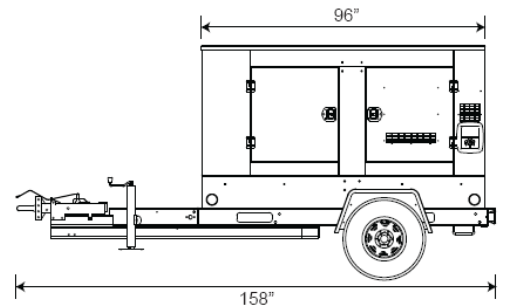
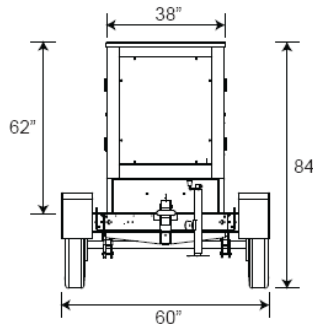

## WARRANTY

- Engine and generator covered under OEM warranty – consult factory for details.

## CERTIFICATIONS

- CSA certified
- 

## AG75 Options

### ENGINE OPTIONS

- In-line engine block heater (Kim Hotstart)
- Fuel transfer pump

### ELECTRICAL CONTROLS OPTIONS

- 720 CCA gel cell battery
- Battery disconnect
- Battery charger – 2A trickle

### GENERATOR OPTIONS

- PMG Generator - critical grade power quality
- Super Start Generator - motor starting applications

### VOLTAGE OUTPUT OPTIONS

- 4 position phase switch
  - Single phase – 120 / 240V Zig Zag
  - Three phase – 120 / 208V Low Wye
  - Three phase – 277 / 480V High Wye
  - Three phase – 120 / 240V Delta
- Dedicated voltage configurations
- Buck Transformer kit – Provides 120V at GFCI outlets when in 277/480V
- Cam locks

### SYSTEM CONTROLS OPTIONS

- Analog gauges
- Auxiliary strobe/audible indication for soft & hard alarm conditions

### COOLANT OPTIONS

- 60/40 Coolant - cold weather applications

### ENCLOSURE OPTIONS

- Fire extinguisher
- Interior cabinet light
- Control panel light

## **FUEL TANK OPTIONS**

- 36 hr. single wall fuel tank (requires tandem axle trailer)
- 21 hr. double wall fuel tank
- 120% Containment

## **TRAILER OPTIONS**

- Single axle trailer w/ electric brakes
- Tandem axle trailer w/ surge brakes
- Tandem axle trailer w/ electric brakes
- 6 pin or 7 spade electrical connectors
- Spare tire/wheel kit

## **HITCH OPTIONS**

- 2" ball
- 2 5/16" ball
- Adjustable height options:
  - 2" ball
  - 2 5/16" ball