

REVISIONS				
NO.	DATE	DESCRIPTION	DATE	APP'D

SYSTEM INTEGRATION DETAILS:

- *OHIO FURNISHED EQUIPMENT INSTALLED BY PRITCHARD-BROWN*
- 1- BATTERY CHARGER
- *PRITCHARD-BROWN FURNISHED EQUIPMENT & SERVICES*
- 1- SILENCER (2" ID) 10' HEIGHT 18" OUTLET (OPTICAL SOUND)
- 1- INSULATION BLANKET FOR EXHAUST SILENCER
- 1- EXHAUST ELBOW & RAINCAP
- 2- EXHAUST FLUES
- 2- INSULATION BLANKETS FOR EXHAUST FLUES
- 2- COOLANT ALGUNE OR DRAIN PORTS AT EXTERIOR
- 1- CONDENSATE DRAIN PIPE (2" DIA) AT EXTERIOR

SHIPPED LOOSE ITEMS:

- 1- RAIN SHIELD RAINCAP ASST
- 1- 2" TIE DOWN KIT
- 1- 30 KVA TRANSFORMER

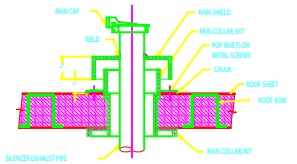

RAIN SHIELD / COLLAR INSTALLATION

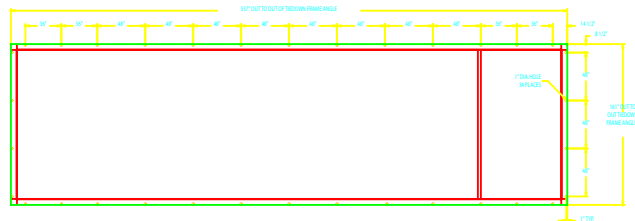

TIEDOWN POINTS

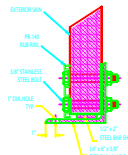

TIEDOWN DETAIL

CUSTOMER		OHIO ENGINE POWER		
REFERENCE:		REVOLUTIONS CENTER - TORONTO		
DESIGN PROJECT:		DESIGN		REVISION
NOTICE TO PERSONS RECEIVING THIS DRAWING:		PRITCHARD-BROWN DIV. OF EDWARDS INDUSTRIES, INC. CLAIMS PROTECTED BY PATENT. THIS DRAWING IS ISSUED FOR YOUR INFORMATION ONLY AND MAY NOT BE REPRODUCED OR USED TO FABRICATE ANYTHING WITHOUT PERMISSION FROM PRITCHARD-BROWN DIV. OF EDWARDS INDUSTRIES, INC.		
PRITCHARD-BROWN DIV. OF EDWARDS INDUSTRIES, INC.		4501 EISENHARTMAN AVE. BALTIMORE, MD 21286		DATE: 07/20/07
552'L x 156"W x 162'H. GENERATOR ENCLOSURE				
CHK:		JOB SERIAL NO.	M011048/49	
APP:		SCALE:	1/2" = 1'-0"	
APP:		SHEET:	1 OF 1	

COMPILED BY: P. HANCOCK